

LOC	DIST	REVISIONS					
CM	00	P	LTR	DESCRIPTION	DATE	DWN	APVD
			D	ECO-07-007260	09APR07	KW	DB
			D1	REVISED PER ECO-09-021510	15AUG09	KK	AEG

1 OBSOLETE PARTS: OBSOLETE CIS STREAMLINING PER D.RENAUD/D.SINISI

DIMENSION IN BRACKET ARE IN INCHES.

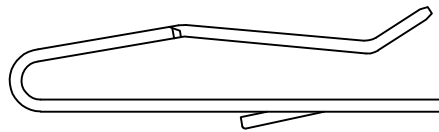
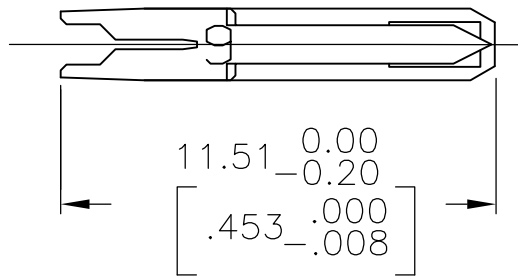

METRIC

1	SUPERSEDED	TIN	641645-2
		TIN-LEAD	641645-1
		FINISH	PART NO

RELEASED FOR PUBLICATION

ALL RIGHTS RESERVED.

BY TYCO ELECTRONICS CORPORATION.

COPYRIGHT

THIS DRAWING IS UNPUBLISHED.

DIMENSIONS: mm [INCHES]	DWN L. SMITH	20JAN94	MATERIAL 0.30[.012] THK COPPER ALLOY	FINISH MATTE TIN OR BRIGHT TIN LEAD 0.00203[.000080] MIN THK		
	CHK R. SWING	20JAN94	Tyco Electronics Corporation Harrisburg, PA 17105-3608			
TOLERANCES UNLESS OTHERWISE SPECIFIED:	APVD E. BEILES	27JAN92			NAME CONTACT,0.36-0.51 [.014-.020] POST LOOSE PEICE 26 AWG WIRE,MTA-100	
0 PLC ± -	PRODUCT SPEC	-	SIZE	CAGE CODE	DRAWING NO	RESTRICTED TO
1 PLC ± -	APPLICATION SPEC	-	A4	00779	C-641645	-
2 PLC ± -	WEIGHT	-	CUSTOMER DRAWING			
3 PLC ± -			SCALE	SHEET	1 OF 1	REV D1
4 PLC ± -			5:1			
ANGLES ± -						

